

# Operating Instructions

DT Forge exists to promote good craftsmanship in a rich variety of materials, using traditional hand crafting techniques, supplemented by modern tooling and processes. Products range from original designs in high quality materials to artefacts made by sensitive recycling of iconic objects with the aim of extending their lifespan.

*“Making something out of the ordinary, out of the ordinary”*

## Model No. TLDJ-100

Upcycled Vintage Brown Demi-John Table Lamp Base with 3 in 1 Dimmable LED Bulb

### Description

An unusual vintage brown glass Demi-John upcycled to create a lamp base which would complement both modern and traditional home interiors. The Demi-John base is 330mm high approximately and 170mm diameter. The lamp is fitted with all new 3-core black electric cable with in-line switch connecting to an Edison Screw (ES) lamp fitting secured via a 10mm diameter threaded brass bung. The cable enters the Demi-John at its base via a grommet filled hole drilled for this purpose and secured with cable restraint.

The lamp is supplied complete with a 3 in 1 LED warm white 95mm diameter globe shaped bulb: i.e. switch on for full brightness; switch off and quickly on again for 30% dimming; then switch off.

Also supplied with a 200mm fabric covered burgundy drum shade to complement the brown Demi-John base resulting in an overall height of approximately 500mm.



### Operating Instructions

- This table lamp is not a toy and not suitable for use by young children
- This lamp is only suitable for connection to a 240V~50Hz supply in accordance with current IEE Wiring Regulations. It is for moisture free, indoor use only, and not suitable for a bathroom location.
- Any plastic protective cover on the shade must be removed prior to use.
- Do not exceed the maximum of a 60 Watt bulb as stated for the drum shade supplied.

### Safeguards and Precautions

- The lamp must be positioned on a stable, flat surface and kept away from flammable materials.
- To prevent damage to the mains cord, do not let it pass over sharp corners, edges or hot surfaces.

- Always unplug the lamp before inserting or replacing the bulb and when replacing allow time for the existing bulb to cool down.
- Full details of the 3-in-1 LED Bulb supplied can be found on its separate packaging.
- Under no circumstances must this table lamp be covered with any material as this could pose a safety hazard.
- Don't let cables or plugs get wet, and keep liquids away from electrical appliances.

## Assembly

- Stand the Lamp Base upright on a flat, stable surface and remove the locking nut from the threaded Lamp Holder
- Position the fabric lampshade over the lamp holder by inserting the threading through the ring on the lampshade. *Note: for postage, the lampshade is packaged upside down. Be sure to turn this the correct way up before positioning on to the lamp holder*
- Secure the lampshade into position by screwing the locking nut back into place.
- Caution: Do Not over tighten the locking nut as this could cause damage to the lamp
- Screw on 1 x E27 9W 3-in-1 LED Bulb as supplied into the Lamp Holder.

## How to Use

- Switch on for warm white with 30% brightness (2700 Kelvin); switch off and on again for neutral white at full brightness (4000 Kelvin); then switch off.

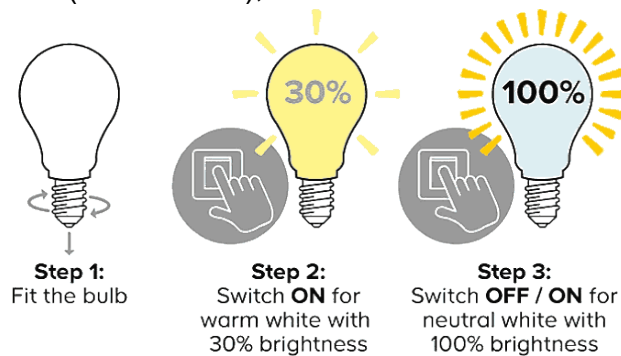

## Care and Maintenance

- When cleaning, unplug and allow to cool then clean surfaces only with a soft dry cloth - do not use liquid or abrasive cleaners.
- In the event of the mains cable becoming frayed or damaged it must only be replaced by a technically competent, qualified person. If you are in any doubt about your competence please consult a qualified electrician.
- The main body of the lamp base is recyclable at your local waste recycling centre and should not be added to normal domestic waste in order to make a contribution to environmental protection.